

1311A-1A

FIGURE 207. WHEEL ASSEMBLY AND CTIS VALVE (SHEET 1 OF 2)

SECTION II

TM 9-2320-366-24P-1

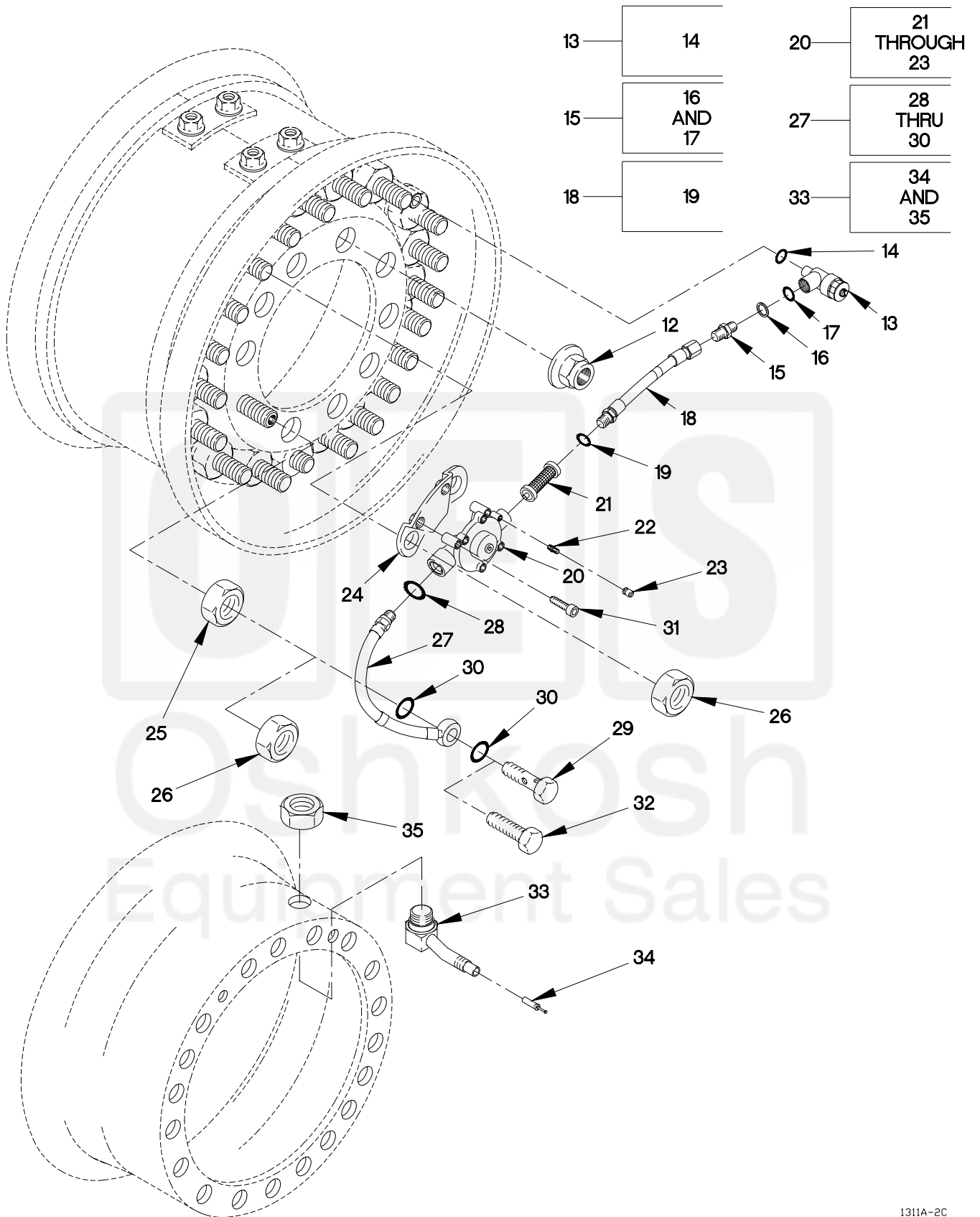

1311A-2C

FIGURE 207. WHEEL ASSEMBLY AND CTIS VALVE (SHEET 2 OF 2)

SECTION II

TM 9-2320-366-24P-1

(1) ITEM NO	(2) SMR CODE	(3) CAGEC	(4) PART NUMBER	(5) DESCRIPTION AND USABLE ON CODE (UOC)	(6) QTY
GROUP 1311: WHEEL ASSEMBLY FIG.207 WHEEL ASSEMBLY AND CTIS VALVE					
1	A00OF	20076	05-10058-00	WHEEL,PNEUMATIC TIR.....	1
2	PA0OF	20076	05-10110-00	.WHEEL,PNEUMATIC TIR.....	1
3	PA0ZZ	0FW39	12417332-001	..BOLT,ECCENTRIC HEAD 5/8-18 X 2 7/16.....	18
4	PA0ZZ	19207	12417332-002	..BOLT,ECCENTRIC HEAD 5/8-18 X 1 9/16.....	2
5	PA0ZZ	20076	OR420A	.O-RING.....	1
6	PA0ZZ	20076	05-10107-00	.WHEEL SEGMENT,PNEUM.....	1
7	PA0ZZ	19207	12301125	.NUT,SELF-LOCKING,EX.....	20
8	PA000	62161	T 1001	BEADLOCK,PNEUMATIC.....	1
9	PA0ZZ	96906	MS90727-58	.SCREW,CAP,HEXAGON H 3/8-24 X 3/4..	4
10	PA0ZZ	19207	12414420-002	.PLATE,MENDING.....	2
11	PA0ZZ	19207	12414420-004	.NUT,SELF-LOCKING,HE.....	4
12	PA0ZZ	19207	10938443-1	NUT,PLAIN,SINGLE BA 3/4-16 (ROAD SIDE).....	27
12	PA0ZZ	19207	10938443-2	NUT,PLAIN,SINGLE BA 3/4-16 (CURB SIDE).....	27
13	PA0ZZ	1MVZ1	673245	VALVE,ANGLE KNEELING,10PSI..... UOC:MAA,MAB,MAC,MAE,MAF,MAH,MAJ,MAK, MAL,MAM,MWB,MWC,MWF,MWH,MWJ,MWL,	1
13	PA0ZZ	0FW39	673246	VALVE,ANGLE KNEELING,12PSI..... UOC:MAG,	1
13	PA0ZZ	19207	12417916	ELBOW,TUBE TO HOSE (SPARE AND REAR TIRES ONLY).....	1
14	PA0ZZ	1MVZ1	5999807	.SEAL,NONMETALLIC RO.....	1
15	PA0ZZ	1MVZ1	673994	ADAPTER,STRAIGHT,TU (FRONT).....	1
15	PA0ZZ	1MVZ1	673995	ADAPTER,STRAIGHT,TU (REAR)..... UOC:MAA,MAB,MAC,MAE,MAF,MAG,MAH,MAJ, MAK,MAL,MAM,MCE,MCD,MCC,MCN,MCF,MCG, MCH,MCS,MCK,MCL,MCM,MWB,MWC,MWF,MWH, MWJ,MWL,MXB,MXC,MXF,MXH,MXJ,MXL,	1
16	PA0ZZ	1MVZ1	673996	.WASHER,SEAL USE ON P/N 673994.....	1
17	PA0ZZ	1MVZ1	673268	.SEAL,NONMETALLIC RO USE ON P/N 673994 AND 673995..... UOC:MAA,MAB,MAC,MAE,MAF,MAG,MAH,MAJ, MAK,MAL,MAM,	1
18	PA0ZZ	1MVZ1	676200	HOSE ASSY, NONMETAL.....	1
19	PA0ZZ	1MVZ1	673268	.SEAL,NONMETALLIC RO.....	1
20	PA0ZZ	1MVZ1	673217	VALVE,PNEUMATIC.....	1
21	PA0ZZ	1MVZ1	599791	.FILTER ELEMENT,FLUI.....	1
22	PA0ZZ	1MVZ1	673215	.VALVE,TANK.....	1

SECTION II

TM 9-2320-366-24P-1

(1) ITEM NO	(2) SMR CODE	(3) CAGEC	(4) PART NUMBER	(5) DESCRIPTION AND USABLE ON CODE (UOC)	(6) QTY
23	PAOZZ	81381	673719	.CAP.....	1
24	PAOZZ	1MVZ1	673222	BRACKET,MOUNTING.....	1
25	PAOZZ	19207	10938444-1	NUT,PLAIN,SINGLE BA 1 1/8-16 LEFT HAND.....	3
25	PAOZZ	19207	10938444-2	NUT,PLAIN,SINGLE BA 1 1/8-16 RIGHT HAND.....	3
26	PAOZZ	96906	MS35691-53	NUT,PLAIN,HEXAGON 5/8-UNF (FOR SPARE TIRE).....	1
27	PAOZZ	1MVZ1	673997	HOSE ASSEMBLY,NONME.....	1
28	PAOZZ	1MVZ1	673269	.O-RING.....	1
29	PAOZZ	1MVZ1	673998	.BOLT,FLUID PASSAGE.....	1
30	PAOZZ	1MVZ1	673999	.SEAL,NONMETALLIC RO.....	2
31	PAOZZ	19207	12414475-224	SCREW,CAP,SOCKET HE M8 X 1.25 X 30.	2
32	PAOZZ	80204	B1821BH063F150N	SCREW,CAP,HEXAGON H 5/8-18 X 1 1/2 (SPARE TIRE ONLY).....	1
33	PAOZZ	17875	VS-1090-ALT	VALVE,PNEUMATIC TIR.....	1
34	PAOZZ	81348	TYV/CL2/TR C1	.VALVE CORE.....	1
35	PAOZZ	17875	265	.NUT,PLAIN,HEXAGON 11/16-16.....	1

END OF FIGURE

